

# 6X6 6-PACK

## EVO 2.5 SYSTEM TYPICAL



**3D RENDERING**

### STATION SPECIFICATIONS

- Evo 2.5 System
- 6' x 6' - 6-Pack
- 54" panel height
- Base feed power
- Beltline power
- Fabric Tackable Acoustic tiles
- Metal Beltline Power tile
- Metal Perforated Air Flow tiles
- Metal Base tiles
- 8" frameless glass top dividers
- FF-FP storage pedestal
- BBF-FP storage pedestal

### FINISHES

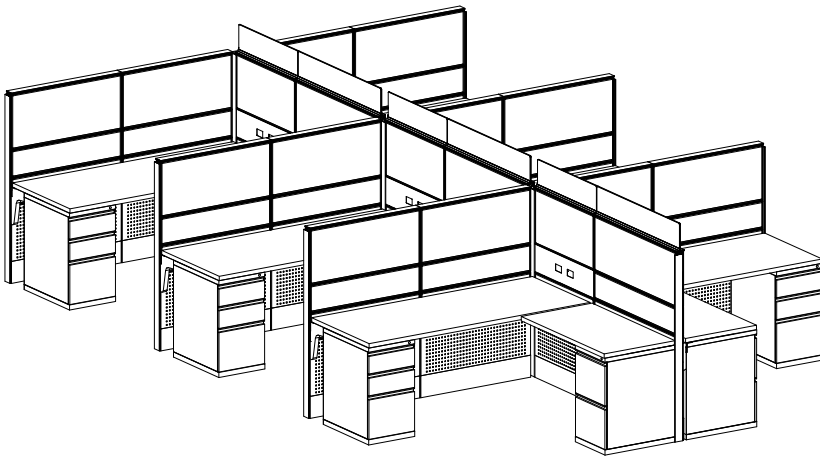
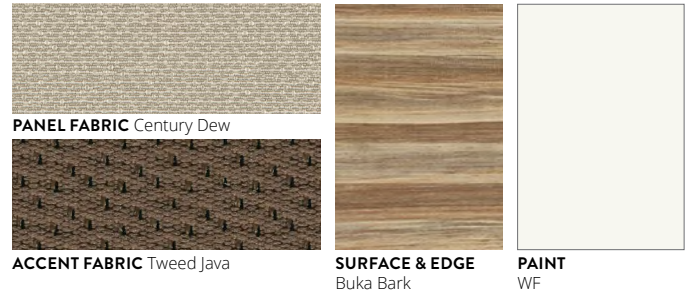

**3D PLAN LAYOUT**

### PRICING

See next page for full BOM.

**\$64,980.00 LIST TOTAL**

**\$10,830.00 PRICE PER STATION**

Typical pricing is for reference only.  
Pricing must be confirmed via official Price Book or Customer Service.

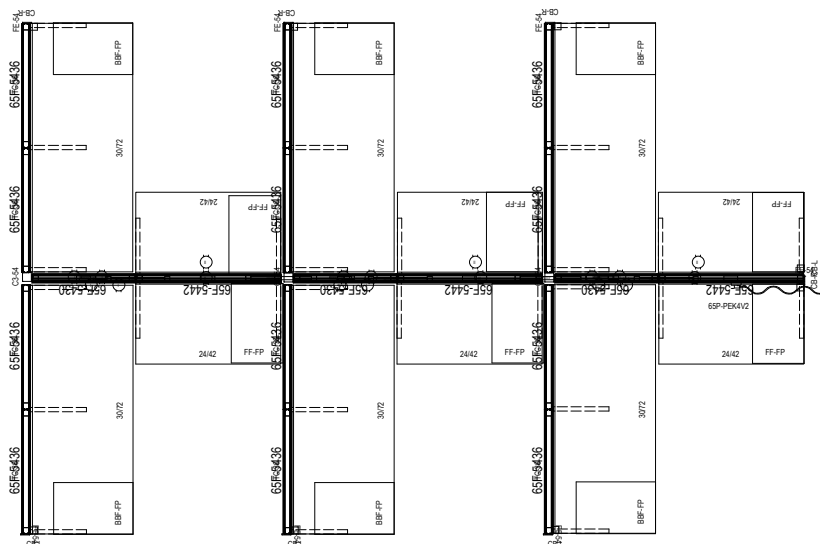

**2D PLAN LAYOUT**

# 6X6 6-PACK

## EVO 2.5 SYSTEM TYPICAL



### PRICING

Part Number	Part Description	Qty	List	Ext List
65-WS3072	30 X 72 Work Surface	6	\$1,015.00	\$6,090.00
65-WS2442	24 X 42 Work Surface	6	\$525.00	\$3,150.00
FF-FP	File/File Pedestal Full Pull 23"D w/o Top	6	\$1,089.00	\$6,534.00
CRNRBR- RIGHT	Corner Bracket (Spec L OR R)	4	\$16.00	\$64.00
CRNRBR- LEFT	Corner Bracket (Spec L OR R)	4	\$16.00	\$64.00
BBF-FP	Box/Box/File Pedestal Full Pull 23"D w/o Top	6	\$1,089.00	\$6,534.00
65TC-36	36"W Top Cap	12	\$54.00	\$648.00
65TA-1642	16"H X 42"W Tack Acoustic Tile	6	\$159.00	\$954.00
65TA-1636	16"H X 36"W Tack Acoustic Tile	24	\$159.00	\$3,816.00
65TA-1630	16"H X 30"W Tack Acoustic Tile	6	\$145.00	\$870.00
65TA-0842	8"H X 42"W Tack Acoustic Tile	12	\$169.00	\$2,028.00
65TA-0836	8"H X 36"W Tack Acoustic Tile	48	\$159.00	\$7,632.00
65TA-0830	8"H X 30"W Tack Acoustic Tile	6	\$159.00	\$954.00
65PMT-0830	8"H X 30"W Mid Pos Metal Tile	6	\$71.00	\$426.00
65P-R-II	Rec Circuit 2	6	\$54.00	\$324.00
65P-R-I	Rec Circuit 1	12	\$54.00	\$648.00
65P-PWR42V1	42" Power Harness-V1	3	\$349.00	\$1,047.00
65P-PWR30V1	30" Power Harness-V1	3	\$245.00	\$735.00
65P-PTP	18.5" Power Festoon Panel to Panel	3	\$119.00	\$357.00
65P-PTC	20.5" POWER FESTOON - CONNECTOR	2	\$115.00	\$230.00
65P-PEK4V2	4 CIR BASE POWER ENTRY	1	\$719.00	\$719.00
65P-BL-ML	49" BASE LINE TO BELT LINE FESTOON	3	\$235.00	\$705.00
65FGA-42-8H.C	8"H X 42"W FRAMELESS GLASS W/TOPCAP-CLEAR	3	\$385.00	\$1,155.00
65FGA-30-8H.C	8"H X 30"W FRAMELESS GLASS W/TOPCAP-CLEAR	3	\$305.00	\$915.00
65FE-54	54"H FINISHED END	7	\$71.00	\$497.00
65F-5442	54"H X 42"W FRAME	3	\$595.00	\$1,785.00
65F-5436	54"H X 36"W FRAME	12	\$565.00	\$6,780.00
65F-5430	54"H X 30"W FRAME	3	\$535.00	\$1,605.00
65C4-54	54"H 4-WAY 90 DEG CONN POST	2	\$255.00	\$510.00
65C3-54	54"H 3-WAY 90 DEG CONN POST	1	\$205.00	\$205.00
65BCE-42	42"W BASE COVER W/KNOCKOUT	3	\$93.00	\$279.00
65BC-42	42"W BASE COVER (BLANK)	3	\$82.00	\$246.00
65BC-36	36"W BASE COVER (BLANK)	24	\$71.00	\$1,704.00
65BC-30	30"W BASE COVER (BLANK)	6	\$65.00	\$390.00
65AFT-1642	16"H X 42"W PERF AIR FLOW TILE	6	\$145.00	\$870.00
65AFT-1636	16"H X 36"W PERF AIR FLOW TILE	24	\$119.00	\$2,856.00
65AFT-1630	16"H X 30"W Perf Air Flow Tile	6	\$109.00	\$654.00

**\$64,980.00 LIST TOTAL**

**\$10,830.00 PRICE PER STATION**

Typical pricing is for reference only.  
Pricing must be confirmed via official  
Price Book or Customer Service.